

## DIELECTRIC FILTER PRELIMINARY SPECIFICATION

**Part No.:** DF1575S10A

**Date:** 2008-05-16

### ELECTRICAL SPECIFICATIONS

	ITEM	SPEC	UNIT
1	Center Frequency [fo]	1575.42	MHz
2	Bandwidth [BW]	$fo \pm 5.0$	MHz
3	Insertion Loss @ Center	3.0 max.	dB
4	Ripple	1.0 max.	dB
5	V.S.W.R. in BW	1.5 max.	dB
6	Attenuation [Absolute Value]	40 min. @ $fo + 123\text{MHz}$	dB
		15 min. @ $fo - 50\text{MHz}$	dB
7	In/Out Impedance	50	ohm
8	Operation Temperature Range	-40 to +85	°C
9	Input Power	1 max.	Watt

### DIMENSIONS

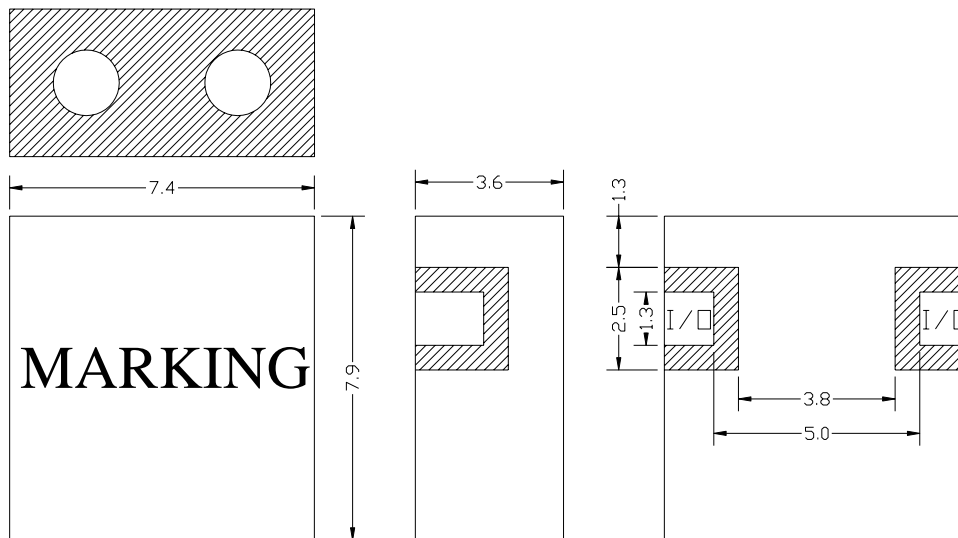

Tolerance:  $\pm 0.2$   
Unit: mm

### RECOMMENDED PC BOARD PATTERN

